

Agenda

2nd Japan-Australia GEO-LEO Applications Workshop
1st and 2nd September 2016, Sola City Conference Centre, Tokyo, Japan
Hosted by JAXA

Background

This workshop is a follow-up to the August 2015 Brisbane workshop on *Non-Meteorological Applications for Next Generation Geostationary Satellites*, which discussed opportunities and limitations of, as well as the resources and personnel needed to realize the potential of new generation geostationary imagers – making the most of Japan's data streams, and Australia's application capabilities. The initiative is primarily focused on (traditionally LEO) applications that benefit from the high temporal resolution of combined GEO and LEO observations.

The purpose of this follow-up meeting is to take stock of the status and outlook for each of the products identified in 2015, and to chart the way forward for the initiative.

Progress reports will be heard from each of the product teams, and the Domain Leads will identify challenges that need to be solved together, as well as opportunities that the team needs to seize. Front-running practical applications will be identified as 'poster children' for the Initiative.

Objectives

- Share the progress of the Product Teams (Land, Ocean and Atmosphere);
- Further discussions around the intercalibration of GEO and LEO datasets, as well as strategies for dealing with the very large data streams;
- Identify challenges and opportunities, and decide the initiative-wide actions needed to address them;
- Discuss and confirm focus projects for the GEO-LEO Initiative (in two key application areas: hotspot/haze monitoring and ocean parameter monitoring (SST, ocean colour)), taking into account end-users and societal values.

sola city Conference Center

Location

◆ Visiting sola city

JR Chuō Line · Sōbu Line : Ochanomizu Station

1min. walk from Hijiribashi Exit

TokyoMetro Chiyoda Line : Shin-Ochanomizu Station

0min. walk from B2 Exit 【Direct link to concourse】

TokyoMetro Marunouchi Line : Ochanomizu Station

4min. walk from 1 Exit

Toei Shinjyuku Line : Ogawamachi Station

6min. walk from B3 Exit

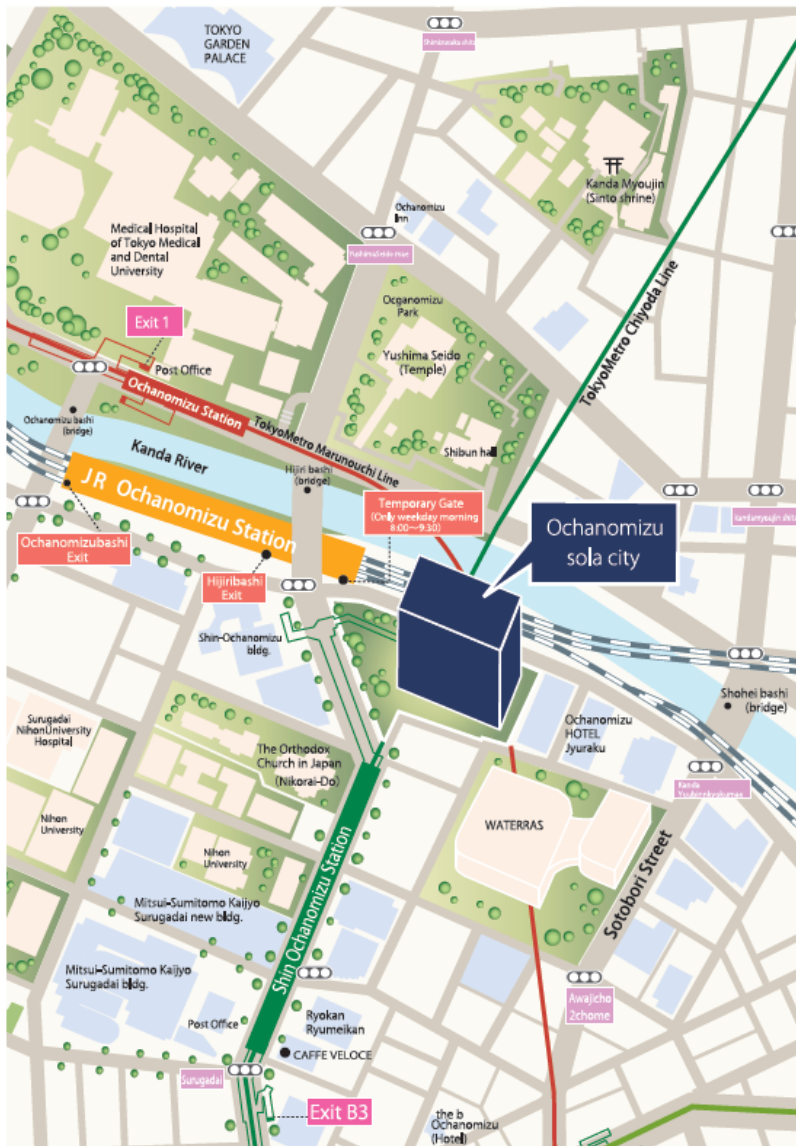
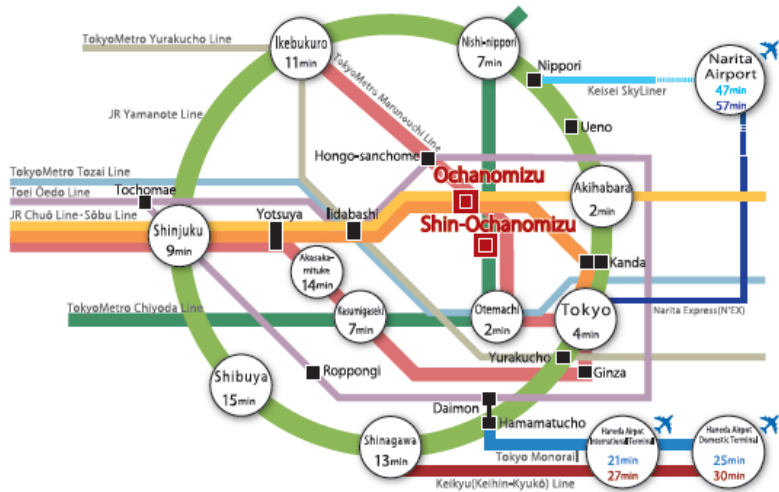

sola city Conference Center

4-6 Kandasurugadai, Chiyoda-ku, Tokyo. 101-0062

Ochanomizu sola city

- ◆ sola city Hall ...2F
- ◆ Terrace Room ...2F
- ◆ Room A, B, C, D ...1F
- ◆ Conference Center Office ...1F

Please use public transportation when visiting sola city Conference Center.

Floor Map

1st Floor, Ochanomizu Sola city

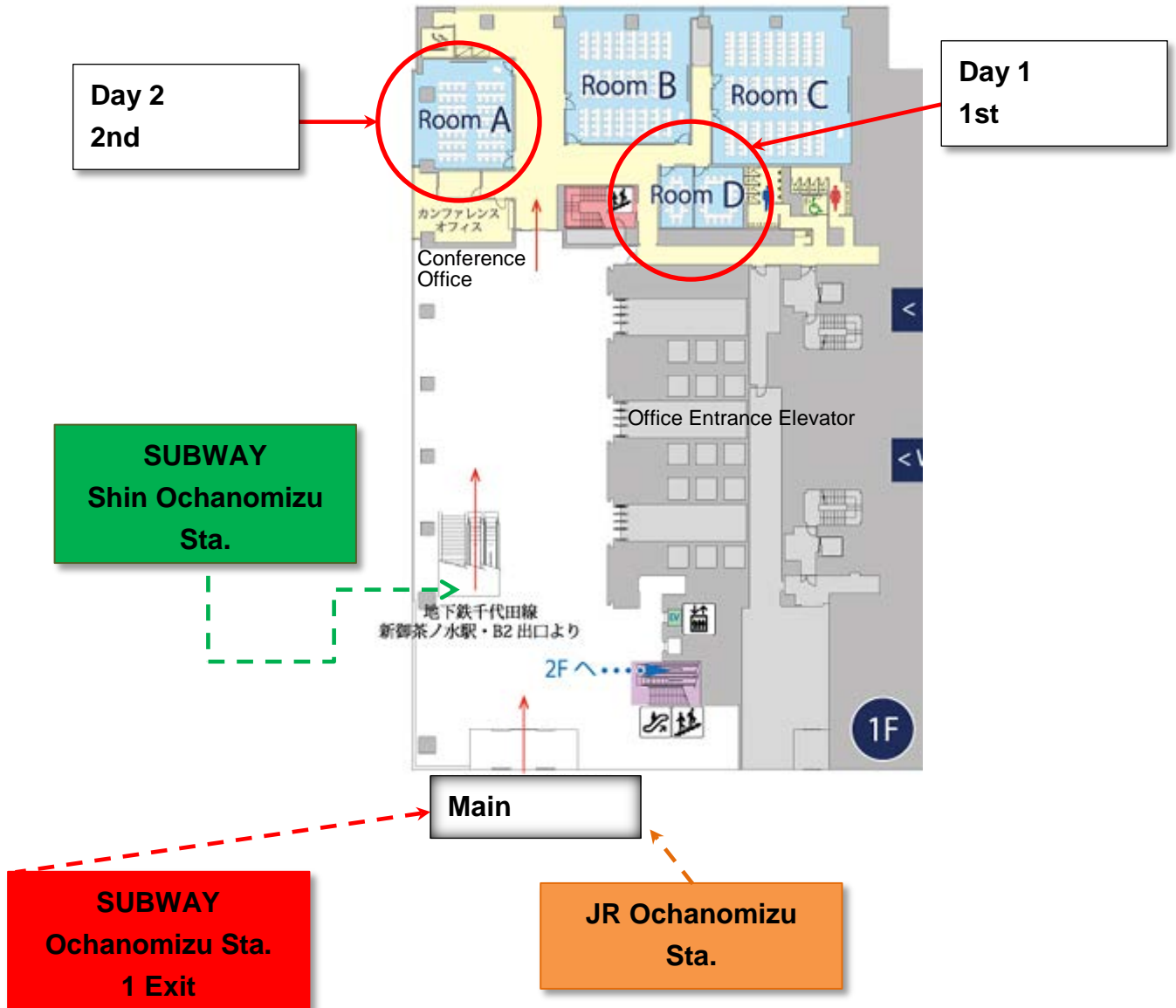

Access from Station

- JR Chuo Line/Sobu Line: Ochanomizu Station, 1 min walk from Hujiribashi Exit
- Tokyo Metro Chiyoda Line: Shin-Ochanomizu Station 0 min walk from B2 Exit [Direct Link]
- Tokyo Metro Marunouchi Line: Ochanomizu Station 4 min walk from 1 Exit

Accommodation

Near the venue (Sola city)

TOKYO MOME HOTEL (<http://www.tokyodome-hotels.co.jp/e/>)

1-3-61 Koraku, Bunkyo-ku, Tokyo TEL 81-3-5805-2111 FAX 81-3-5805-2200

Price: 25,148JPY (Single)

To Venue: 10 min. by train / 20 min on foot / 10 min by taxi

HOTEL NIWA TOKYO (<http://www.hotelniwa.jp/english/index.html>)

1-1-16 Misaki-cho, Chiyoda-ku, Tokyo TEL 81-3-3293-0028 FAX 81-3-3295-3328

Price: approx.27,000JPY (Standard)

To Venue: 10 min. by train / 15 min on foot / 10 min by taxi

Near Tokyo Station

Hotel Metropolitan Tokyo Marunouchi (<http://www.hotelmetropolitanmarunouchi.jp/>)

1-7-12 Marunouchi Chiyoda-ku Tokyo TEL81332112233 Email:

info@hm-marunouchi.jp

Price: approx.23,000JPY (Double)

To Venue: 15 min. by train / 15 min. by taxi

Hotel Ryumeikan Tokyo (<http://www.ryumeikan-tokyo.jp/english/>)

1-3-22 Yaesu Chuo-ku Tokyo TEL 81-3-3271-09

Email:reservation_hrt@ryumeikan.co.jp

Price: 20,000JPY (Standard single)

To Venue: 20 min. by train / 15 min. by taxi

Commercial Hotels

remm AKIHABARA

(http://www.hankyu-hotel.com/cgi-bin2/cms2/index_en.cgi?hid=51remmakihabara)

1-6-5 Kandasakuma-cho,Chiyoda-ku,Tokyo TEL 81-3-3254-0606

http://www.hankyu-hotel.com/cgi-bin2/cms2/index_en.cgi?hid=51remmakihabara

Price: approx.19,000JPY (Single)

To Venue: 10 min. by train / 10 min on foot / 5 min by taxi

Tokyu Stay Suidobashi Hotel (<http://www.tokyustay.co.jp/e/hotel/SUI/>)

1-1-12 Misaki-cho, Chiyodaku, Tokyo TEL 81-3-3293-0109

Price: approx.14,000JPY (Single)

To Venue: 10 min. by train / 15 min on foot / 10 min by taxi

Day 1 (1st September)

Room D, Sola City Conference Centre

- 08:30 – 09:00 Registration
- 09:00 – 09:10 Welcome & self-introductions
- 09:10 – 09:20 Process & context
Matt Steventon (Symbios)
- 09:20 – 09:35 Advanced performance of Himawari-8 in operation
Kazumi Kamide (JMA)
- 09:35 – 09:50 Himawari-8 related activities in CEReS, Chiba University
Atsushi Higuchi (Chiba University)

Session 1 **Status report from the Land, Ocean, and Atmosphere Product Teams** (10 min each, *only* products not covered under Sessions 2 and 3)

Chair: Shin-ichi Sobue (JAXA)

- 09:50 – 10:50 *Land*
Koji Kajiwara (Chiba University)
Luigi Renzullo (CSIRO)
- Ocean*
Hiroshi Murakami (JAXA)
Tim Malthus (CSIRO)
- Atmosphere*
Teruyuki Nakajima (JAXA)
Ian Grant (BOM)

- 10:50 – 11:10 Group Photo & Coffee Break

Session 2 **Hotspot detection and haze/aerosol monitoring**

Chair: Shin-ichi Sobue (JAXA)

- 11:10 – 11:25 Proposal of observation framework with Himawari-8 and GCOM-C for biomass burning monitoring
Koji Kajiwara (Chiba University)
- 11:25 – 11:40 Hotspot detection and haze monitoring
Dr. Koji Nakau (JAXA)

- 11:40 – 11:55 Aerosol products from Himawari-8 and health impacts of smoke in Australia
Ilan Grant (BoM)
- 11:55 – 12:10 Aerosol monitoring
Maki Kikuchi (JAXA)
- 12:10 – 12:25 Himawari products for Asian dust monitoring by JMA
Daisaku Uesawa (JMA)
- 12:25 – 12:40 Integrating hotspot measurements from Himawari-8 into the Sentinel bushfire monitoring system
Medhavy Thankappan (GA)
- 12:40 – 12:55 Dynamic ecological observations from satellites inform aerobiology of allergenic grass pollen
Alfredo Huete (UTS)
- 12:55 – 14:00 Lunch
- Session 3 Ocean colour and sea surface temperature monitoring**
- Chair: Shin-ichi Sobue (JAXA)**
- 14:00 – 14:15 Ocean colour products from satellite data
Hiroshi Murakami (JAXA)
- 14:15 – 14:30 Sea Surface Temperature (SST) products from satellite data
Misako Kachi (JAXA)
- 14:30 – 14:45 Sea Surface Temperature monitoring for the Western North Pacific at JMA
Toshiyuki Sakurai (JMA)
- 14:45 – 15:00 Coastal applications and IMOS validation support for Himawari-8 (Title TBC)
Tim Malthus (CSIRO)
- 15:00 – 15:15 Australian BoM sea surface temperature products from Himawari-8 and LEO missions
Ilan Grant (BoM)
- 15:15 – 15:30 Dredge and flood plume remote sensing
Peter Fearn (Curtin University)
- 15:30 – 15:45 Arrangement of the room for breakout sessions and coffee break

Session 4 Breakout sessions (2 groups)

15:45 – 17:20 Participants will discuss focus projects for the GEO-LEO Initiative, considering two application areas as front-running practical applications:

- Hotspot detection and haze/aerosol monitoring (**Co-Chairs: Shin-ichi Sobue (JAXA), Ian Grant (BoM)**)
- Ocean colour and sea surface temperature monitoring (**Co-Chairs: Hiroshi Murakami (JAXA), Tim Malthus (CSIRO)**)

Discussion will take into account end-users and societal values.

Objectives:

- Bring together the appropriate experts and discuss the details of specific projects;
- Develop a work plan including goals, requirements, necessary resources, expected outputs, and milestones.

17:20 Day 1 Adjourn

Day 2 (2nd September)

Room A, Sola City Conference Centre

Session 5 Breakout sessions (2 groups, cont.)

09:00 – 10:30 Breakout sessions (cont.)

Session 6 Wrap-up

Chair: Shin-ichi Sobue (JAXA)

10:30 – 11:30 Breakout sessions report and discussion (30 mins each)

11:30 – 12:30 Lunch

12:30 – 13:30 GEO-LEO report to APRSAF and CEOS
– Discussion, actions & way forward

13:30 – 14:00 Workshop wrap-up
TBD (CSIRO, Symbios)

14:00 Day 2 Adjourn

GoToMeeting Connection Details for Remote Participants

Primary Line

- *Main meeting*
- *Breakout session #1: Hotspot detection and haze/aerosol monitoring*

<https://global.gotomeeting.com/join/925708813>

Use your microphone and speakers (VoIP) – a headset is recommended. Or, call in using your telephone:

United States: +1 (646) 749-3117

Australia: +61 2 8355 1039

Access Code: 925-708-813

Audio PIN: Shown after joining the meeting

Meeting ID: 925-708-813

Secondary Line

- *Breakout session #2: Ocean colour and sea surface temperature monitoring*

<https://global.gotomeeting.com/join/580945789>

Use your microphone and speakers (VoIP) - a headset is recommended. Or, call in using your telephone.

United States: +1 (312) 757-3117

Australia: +61 2 8355 1039

Access Code: 580-945-789

Audio PIN: Shown after joining the meeting

Meeting ID: 580-945-789